

ART. 70

Giunti tre pezzi F/F, aisi 316 / A4

Unions F/F, aisi 316 / A4

Esecuzione: Microfusione

Execution: Microcasting

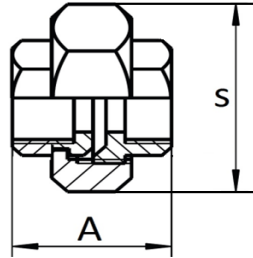
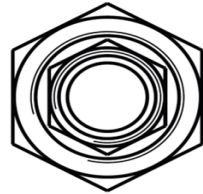

Filettatura: conforme a EN 10226-1 (EX ISO 7-1)

(filetto maschio conico, filetto femmina cilindrico)

Conicità 1:16 sul diametro

Angolo del filetto 55°

Pressione massima d'esercizio 150 Lbs (Libbre) = 10,34 BAR PN10



Codice Articolo <i>Item Number</i>	M size	DN/ID	A (mm)	S (mm)	Box	Master carton
00700001804	1/8"	6	25	29,1	5	/
00700001404	1/4"	8	33,9	29,1	5	/
00700003804	3/8"	10	36	34	5	250
00700001204	1/2"	15	39	37,5	5	150
00700003404	3/4"	20	41	44,5	5	100
00700010004	1"	25	50	53,5	5	50
00700011404	1"1/4	32	51	64	5	30
00700011204	1"1/2	40	57	71,5	5	25
00700020004	2"	50	62	85,5	2	16
00700021204	2"1/2	65	68,5	101	1	/
00700030004	3"	80	78	117	1	/

Thread: according to EN 10226-1 (EX ISO 7-1)

(conical male thread, cylindrical female thread)

Taper 1:16 on diameter

Angle of threads 55°

Maximum operating pressure 150 lbs = 10,34 Bar PN 10

ART. 71

Giunti tre pezzi M/F, aisi 316 / A4

Unions M/F, aisi 316 / A4

Esecuzione: Microfusione

Execution: Microcasting

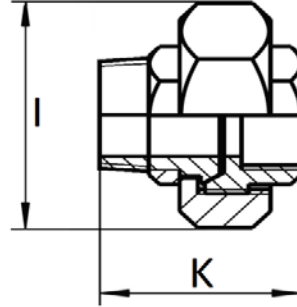
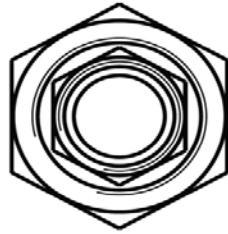

Filettatura: conforme a EN 10226-1 (EX ISO 7-1)

(filetto maschio conico, filetto femmina cilindrico)

Conicità 1:16 sul diametro

Angolo del filetto 55°

Pressione massima d'esercizio 150 Lbs (Libbre) = 10,34 BAR PN10

Thread: according to EN 10226-1 (EX ISO 7-1)

(conical male thread, cylindric female thread)

Taper 1:16 on diameter

Angle of threads 55°

Maximum operating pressure 150 lbs = 10,34 Bar PN 10

Codice Articolo <i>Item Number</i>	M <i>size</i>	DN/ID	L <i>(mm)</i>	K <i>(mm)</i>	Box	Master carton
00710001804	1/8"	6	29,1	35,5	5	/
00710001404	1/4"	8	29,1	46	5	/
00710003804	3/8"	10	34	47,5	5	/
00710001204	1/2"	15	37,5	53,6	5	100
00710003404	3/4"	20	44,5	58,3	5	60
00710010004	1"	25	53,5	69	5	35
00710011404	1"1/4	32	64	71,1	5	/
00710011204	1"1/2	40	71,5	80	5	/
00710020004	2"	50	85,5	88,2	2	/
00710021204	2"1/2	65	108,5	101	1	/